

Bharati Vidyapeeth College of Pharmacy, Kolhapur

Near Chitranagari, Kolhapur-416013, Maharashtra, India.

Website: <http://copkolhapur.bharatividvapeeth.edu>

Criterion 4

Infrastructure and Learning Resources

Key Indicator 4.1 Physical Facilities

4.1.1 The Institution has adequate infrastructure and other facilities for

a. teaching – learning, viz., classrooms, laboratories, computing equipment etc

b. ICT – enabled facilities such as smart class, LMS etc. Facilities for Cultural and sports activities, yoga centre, games (indoor and outdoor), Gymnasium, auditorium etc.

Bharati Vidyapeeth College of Pharmacy, Kolhapur

Near Chitranagari, Kolhapur-416013, Maharashtra, India.

Website: <http://copkolhapur.bharatividvapeeth.edu>

INDEX

| Sr. No. | Particulars | Page No. |
|--------------|--|--------------|
| 4.1 | Physical Facilities | 1-63 |
| 4.1.1 | 1. Classrooms | 1-7 |
| | 2. Faculty rooms | 8-11 |
| | 3. Laboratories | 12-20 |
| | 4. Common Facilities Centre | 21-25 |
| | 5. Machine Room | 26-30 |
| | 6. Training and placement cell | 31-34 |
| | 7. Cultural Activities | 35 |
| | 8. Gymnasium | 36-37 |
| | 9. ICT Facilities | 38-41 |
| | 10. Sport - Outdoor Games and Indoor games | 42-45 |
| | 11. NSS Activity | 46 |
| | 12. Yoga Centre | 47-49 |
| | 13. Drug Museum | 50-52 |
| | 14. Medicinal Plant Garden | 53-60 |
| | 15. Auditorium | 61 |
| | 16. Canteen Facility | 62-63 |

Bharati Vidyapeeth College of Pharmacy, Kolhapur

Near Chitranagari, Kolhapur-416013, Maharashtra, India.

Website: <http://copkolhapur.bharatividyaeeeth.edu>

1: Classrooms

The facilities for conducting theory classes are adequate. The classrooms are well equipped with conventional to advanced tools necessary for teaching and learning. The advanced tools and facilities include Wi-Fi facility, LCD projectors, Audio system, Webinars. The above amenities ensure proper ambience for teaching-learning process. Classrooms and tutorial rooms are well lit, adequately ventilated with uninterrupted power supply. Seminar hall is provided for conducting seminars, guest lectures and other interactions. The carpet area details of the classrooms are provided in the table below.

| Class room Description | Class room number | Carpet area in sq. m | Seating capacity | Availability of OHP/LCD Projector/ Wi-Fi facility |
|------------------------|-------------------|----------------------|------------------|---|
| Class Room-I | F1 | 94 | 50 | Podium, LCD Projector with LAN / Wi-Fi facility, Internet, Board, Smart Board |
| Class Room-II | F8 | 94 | 50 | Podium, LCD Projector with LAN / Wi-Fi facility, Internet, Board, Smart Board |
| Class Room-III | F14 | 45 | 50 | Podium, LCD Projector with LAN / Wi-Fi facility, Internet, Board, Smart Board |
| Class Room-IV | S3 | 94 | 50 | Podium, LCD Projector with LAN / Wi-Fi facility, Internet, Board, Smart Board |
| Class Room-V | S22 | 93 | 50 | Podium, LCD Projector with LAN / Wi-Fi facility, Internet, Board, Smart Board |
| Class Room-VI | SE23 | 94 | 50 | Podium, LCD Projector with LAN / Wi-Fi facility, Internet, Board, Smart Board |
| Class Room-VII | T1 | 94 | 50 | Podium, LCD Projector with LAN / Wi-Fi facility, Internet, Board, Smart Board |
| Class Room-VIII | T6 | 53 | 50 | Podium, LCD Projector with LAN / Wi-Fi facility, Internet, Board, Smart Board |

Bharati Vidyapeeth College of Pharmacy, Kolhapur

Near Chitranagari, Kolhapur-416013, Maharashtra, India.

Website: <http://copkolhapur.bharatividyaeeeth.edu>

| | | | | |
|----------------------------|-----|-----|-----|---|
| Class Room-IX | TE9 | 94 | 50 | Podium, LCD Projector with LAN / Wi-Fi facility, Internet, Board, Smart Board |
| Computer & Language Lab-I | F2 | 48 | 50 | LAN / Wi-Fi facility, Internet, Board |
| Computer & Language Lab-II | F6 | 60 | 50 | LAN / Wi-Fi facility, Internet, Board |
| Seminar Hall | S18 | 62 | 50 | Podium, LCD Projector with LAN / Wi-Fi facility, Internet, Board |
| Auditorium | G23 | 285 | 300 | All Audio-visual system are present |

Layout:

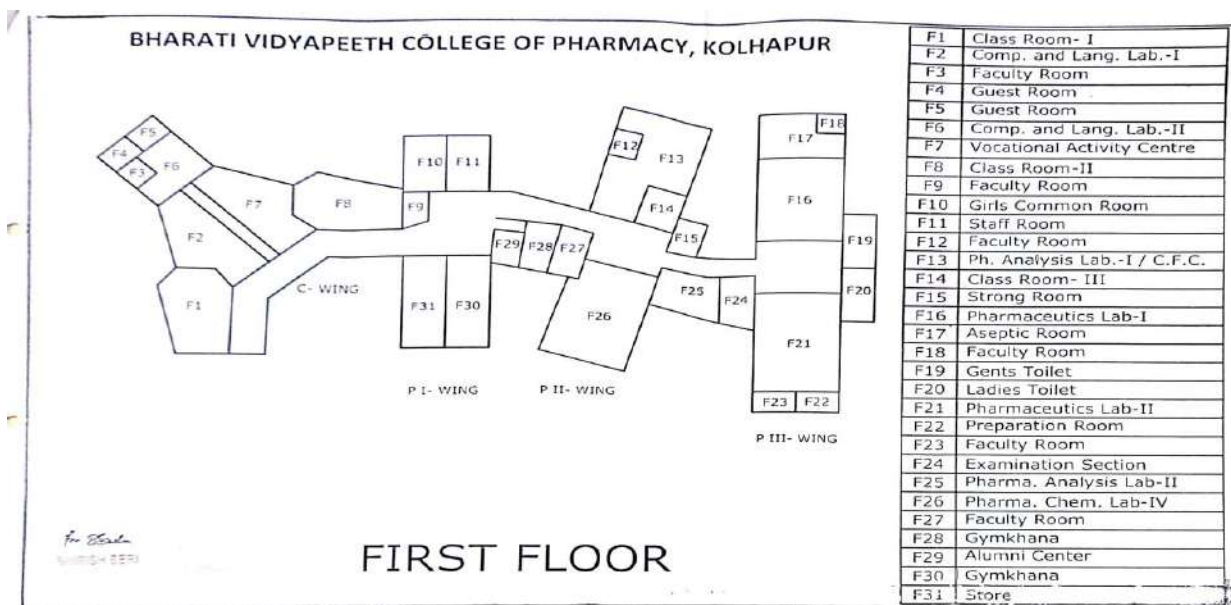

Bharati Vidyapeeth College of Pharmacy, Kolhapur

Near Chitranagari, Kolhapur-416013, Maharashtra, India.

Website: <http://copkolhapur.bharatividyaeeeth.edu>

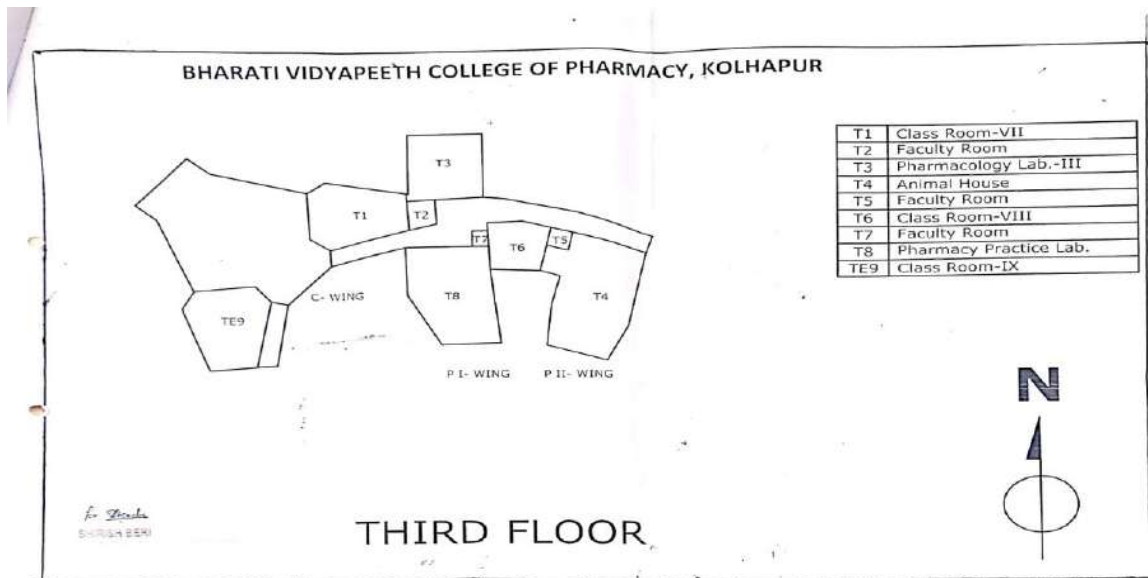
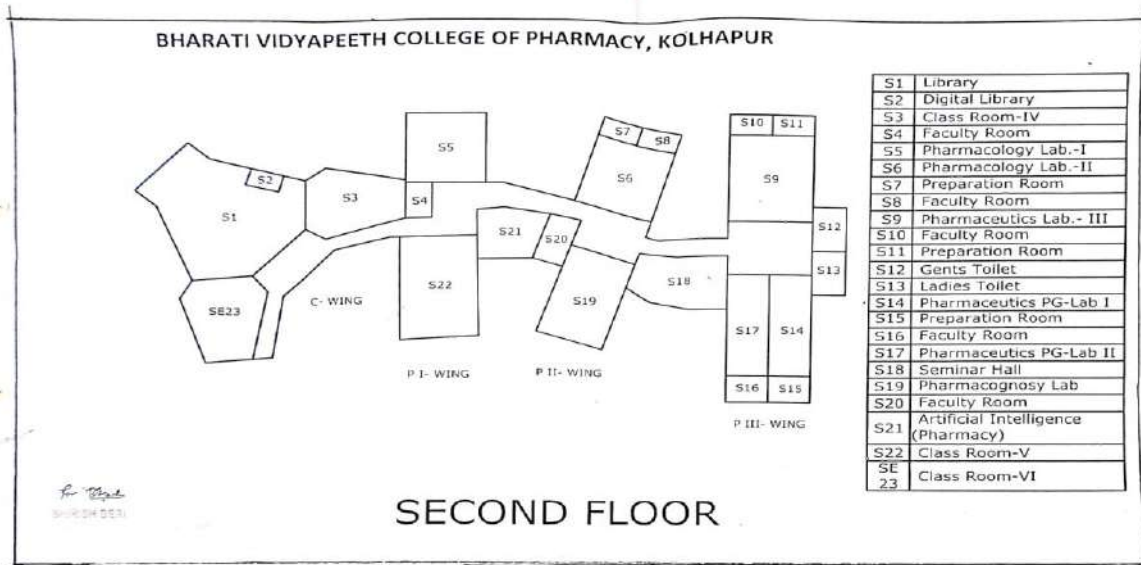

Bharati Vidyapeeth College of Pharmacy, Kolhapur

Near Chitranagari, Kolhapur-416013, Maharashtra, India.

Website: <http://copkolhapur.bharatividyaepeth.edu>

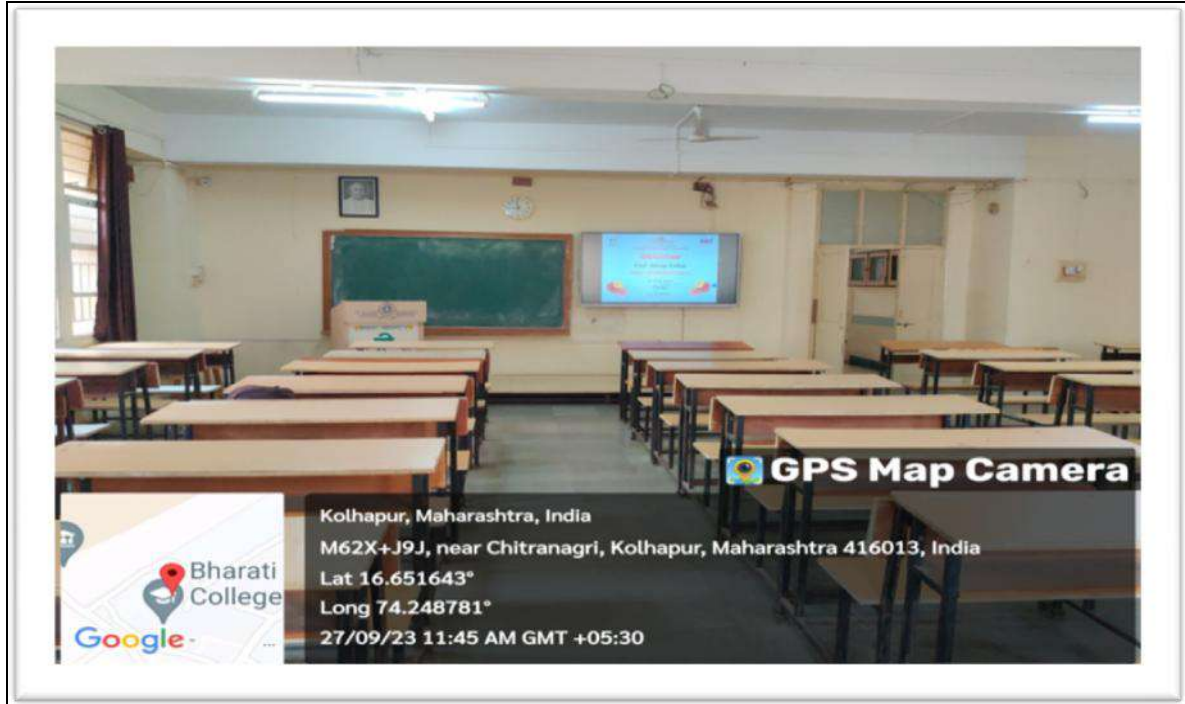

Bharati Vidyapeeth College of Pharmacy, Kolhapur

Near Chitranagari, Kolhapur-416013, Maharashtra, India.

Website: <http://copkolhapur.bharatividyaeeeth.edu>



Bharati Vidyapeeth College of Pharmacy, Kolhapur

Near Chitranagari, Kolhapur-416013, Maharashtra, India.

Website: <http://copkolhapur.bharatividyaepeth.edu>



Bharati Vidyapeeth College of Pharmacy, Kolhapur

Near Chitranagari, Kolhapur-416013, Maharashtra, India.

Website: <http://copkolhapur.bharatividyaeeeth.edu>



Bharati Vidyapeeth College of Pharmacy, Kolhapur

Near Chitranagari, Kolhapur-416013, Maharashtra, India.

Website: <http://copkolhapur.bharatividyaeeeth.edu>

2: Faculty rooms

Adequate and well-furnished faculty rooms/cabins are provided to accommodate department heads and faculty members. The faculty members have been provided with computers, internet, and intercom facilities. LAN and Wi-Fi connectivity is also available.

| Room No | Room type | Carpet area in sq. m |
|------------|------------------|----------------------|
| G7 | HOD Pharm. Chem. | 10 |
| G6 | Faculty Room-1 | 10 |
| G10 | Faculty Room-2 | 10 |
| G15 | Faculty Room-3 | 18 |
| G21 | Faculty Room-4 | 11 |
| GE27 | Faculty Room-5 | 10 |
| F3 | Faculty Room-6 | 10 |
| S4 | Faculty Room-7 | 10 |
| F9 | Faculty Room-8 | 10 |
| F12 | Faculty Room-9 | 10 |
| F18 | Faculty Room-10 | 10 |
| F23 | Faculty Room-11 | 16 |
| F27 | Faculty Room-12 | 36 |
| S8 | Faculty Room-13 | 11 |
| S10 | Faculty Room-14 | 8 |
| S16 | Faculty Room-15 | 10 |
| S20 | Faculty Room-16 | 21 |
| T2 | Faculty Room-17 | 11 |
| T5 | Faculty Room-18 | 10 |
| T7 | Faculty Room-19 | 10 |
| Total Area | | 252 |

Bharati Vidyapeeth College of Pharmacy, Kolhapur

Near Chitranagari, Kolhapur-416013, Maharashtra, India.

Website: <http://copkolhapur.bharatividyaepeth.edu>

Layout:

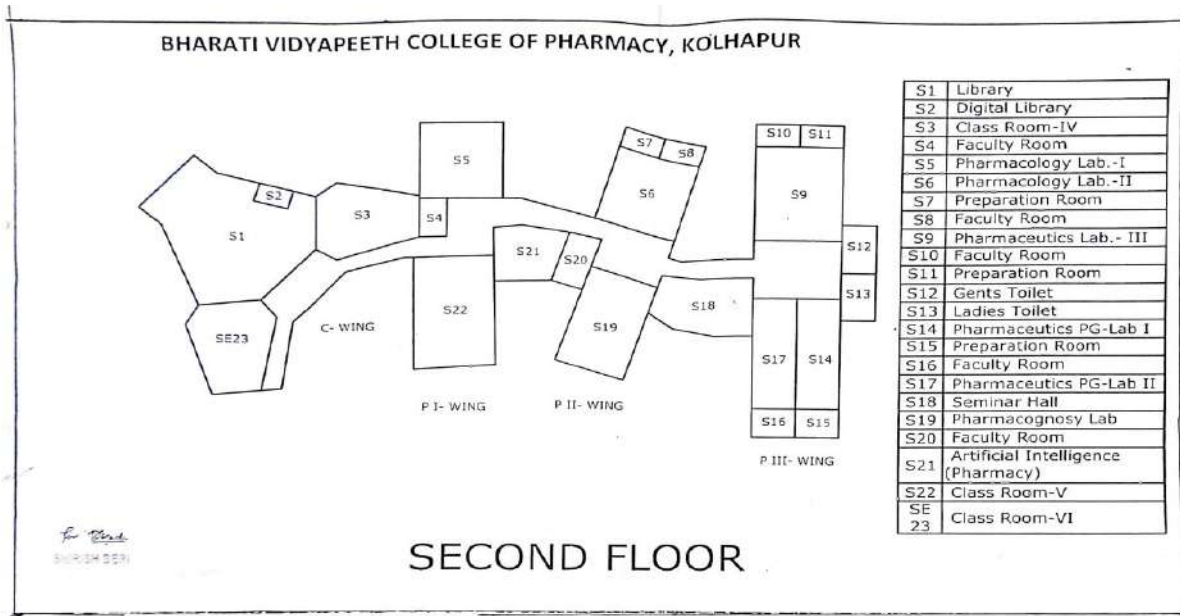
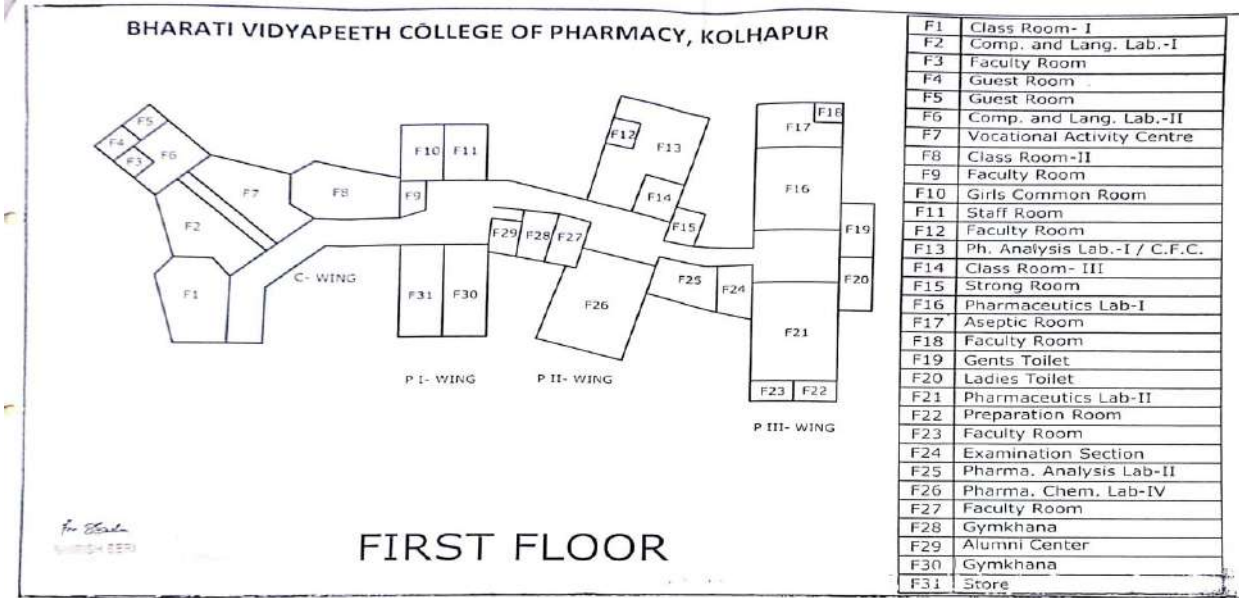

Bharati Vidyapeeth College of Pharmacy, Kolhapur

Near Chitranagari, Kolhapur-416013, Maharashtra, India.

Website: <http://copkolhapur.bharatividyaeeeth.edu>

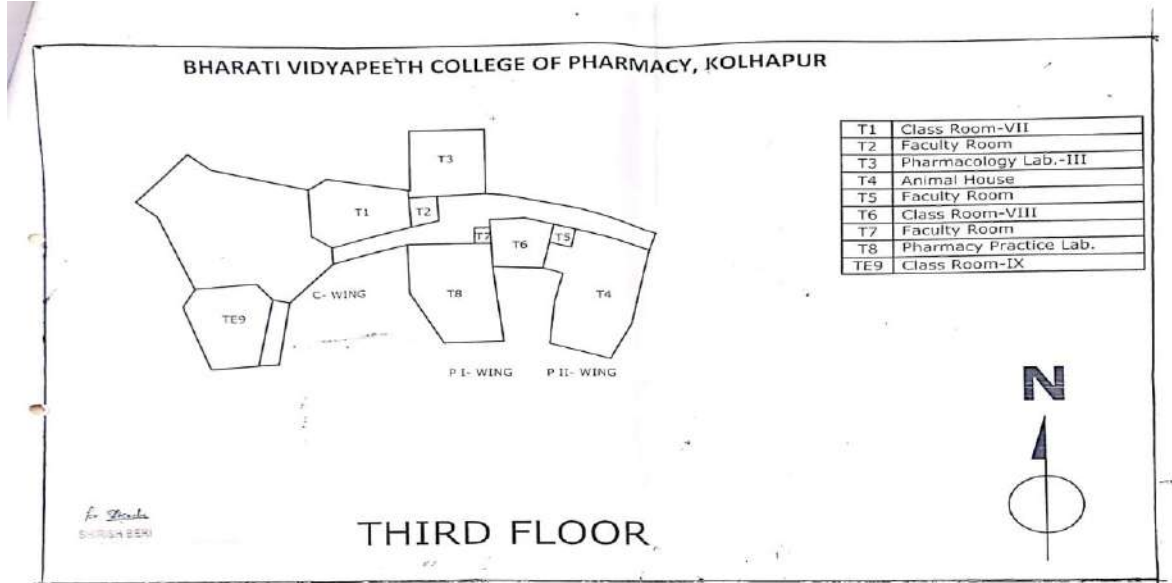

Faculty room:

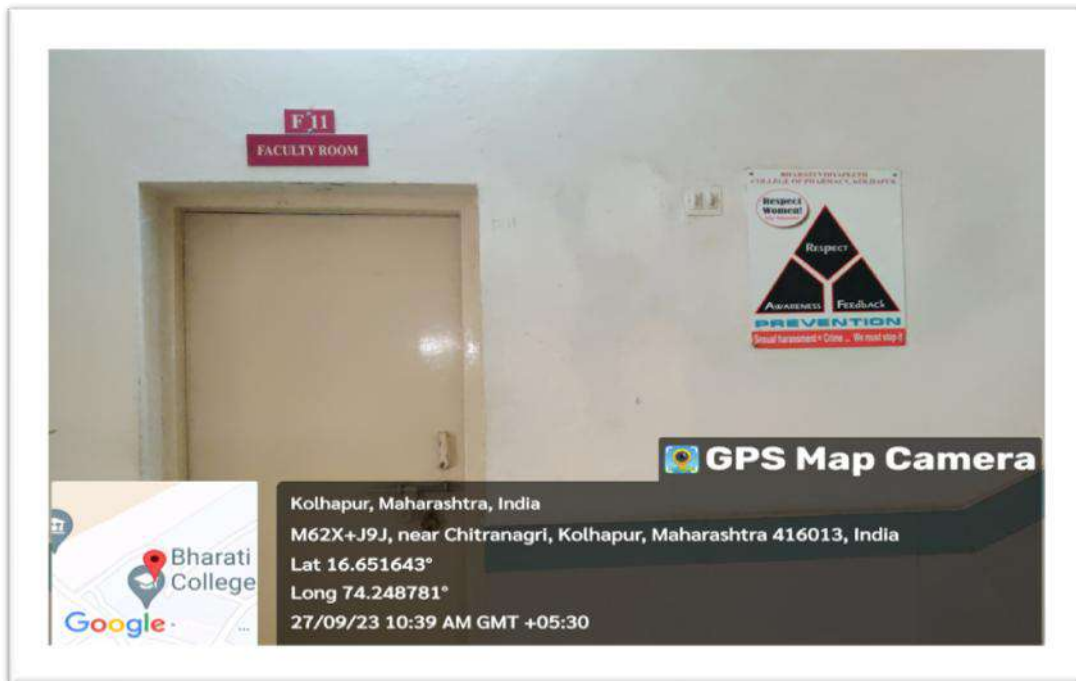

Bharati Vidyapeeth College of Pharmacy, Kolhapur

Near Chitranagari, Kolhapur-416013, Maharashtra, India.

Website: <http://copkolhapur.bharatividyaeeeth.edu>

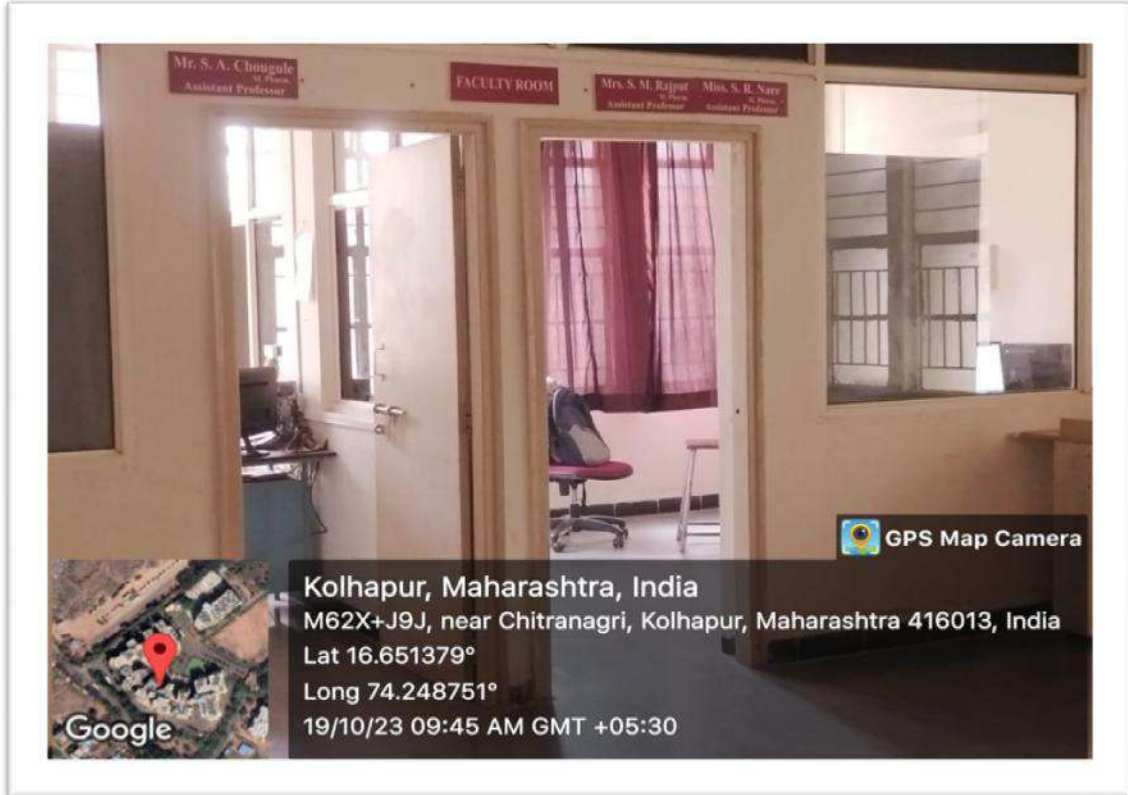

Bharati Vidyapeeth College of Pharmacy, Kolhapur

Near Chitranagari, Kolhapur-416013, Maharashtra, India.

Website: <http://copkolhapur.bharatividyaeeeth.edu>

3: Laboratories

| Lab Description | Batch size Area in sq. m | Availabili ty of Manuals | Quality of instruments | Safety measures |
|--------------------------------------|-----------------------------|--------------------------------|---|--------------------|
| Computer & Language Lab-I | 20 48 sq. m | Yes | Computers/ Scanner/ Printers | Yes |
| Computer & Language Lab-II | 20 60 sq. m | Yes | Computers/ Scanner/ Printers | Yes |
| UG Pharm. Chem. Lab-I | 20 145 sq. m | Yes | Good quality and well maintained | Yes |
| UG Pharm. Chem. Lab-II | 20 100 sq. m | Yes | Good quality and well maintained | Yes |
| UG Pharm. Chem. Lab-III | 20 100 sq. m | Yes | Good quality and well maintained | Yes |
| UG Pharm. Chem. Lab-IV | 20 108 sq. m | Yes | Good quality and well maintained | Yes |
| UG Pharm. Analysis Lab-I (C.F.C.) | 20 78 sq. m | Yes | Good quality and well maintained | Yes |
| UG Pharm. Analysis Lab-II | 20 75 sq. m | Yes | Good quality and well maintained | Yes |
| UG Pharmaceutics Lab-I | 20 75 sq. m | Yes | Good quality and well maintained | Yes |
| UG Pharmaceutics Lab-II | 20 90 sq. m | Yes | Good quality and well | Yes |

Bharati Vidyapeeth College of Pharmacy, Kolhapur

Near Chitranagari, Kolhapur-416013, Maharashtra, India.

Website: <http://copkolhapur.bharatividyaeeeth.edu>

| | | | | |
|--------------------------------|-----------------|-----|----------------------------------|-----|
| | | | maintained | |
| UG Pharmaceutics Lab-III | 20 156 sq. m | Yes | Good quality and well maintained | Yes |
| UG Pharmacology Lab-I | 20 90 sq. m | Yes | Good quality and well maintained | Yes |
| UG Pharmacology Lab-II | 20 110 sq. m | Yes | Good quality and well maintained | Yes |
| UG Pharmacology Lab-III | 20 90 sq. m | Yes | Good quality and well maintained | Yes |
| UG Pharmacognosy Lab | 20 97 sq. m | Yes | Good quality and well maintained | Yes |
| UG Pharmacy Practice Lab | 20 80 sq. m | Yes | Good quality and well maintained | Yes |
| UG Artificial Intelligence Lab | 46 sq. m | Yes | Good quality and well maintained | Yes |
| Machine Room | -- 100 sq. m | Yes | Good quality and well maintained | Yes |
| Preparation Room-1 | 9 sq. m | Yes | Good quality and well maintained | Yes |
| Preparation Room-2 | 13 sq. m | Yes | Good quality and well maintained | Yes |
| Preparation Room-3 | 17 sq. m | Yes | Good quality and well | Yes |

Bharati Vidyapeeth College of Pharmacy, Kolhapur

Near Chitranagari, Kolhapur-416013, Maharashtra, India.

Website: <http://copkolhapur.bharatividyaeeeth.edu>

| | | | | |
|--------------------|----------|-----|----------------------------------|-----|
| | | | maintained | |
| Preparation Room-4 | 10 sq. m | Yes | Good quality and well maintained | Yes |
| Preparation Room-5 | 9 sq. m | Yes | Good quality and well maintained | Yes |
| Preparation Room-6 | 15 sq. m | Yes | Good quality and well maintained | Yes |
| Preparation Room-7 | 25 sq. m | Yes | Good quality and well maintained | Yes |
| Preparation Room-8 | 21 sq. m | Yes | Good quality and well maintained | Yes |
| Preparation Room-9 | 14 sq. m | Yes | Good quality and well maintained | Yes |
| Balance Room | 14 sq. m | Yes | Good quality and well maintained | Yes |

Bharati Vidyapeeth College of Pharmacy, Kolhapur

Near Chitranagari, Kolhapur-416013, Maharashtra, India.

Website: <http://copkolhapur.bharatividyaepeth.edu>



Pharmaceutics lab 1



Pharmaceutics lab II

Bharati Vidyapeeth College of Pharmacy, Kolhapur

Near Chitranagari, Kolhapur-416013, Maharashtra, India.

Website: <http://copkolhapur.bharatividyaeeeth.edu>



Pharmaceutics lab III



Bharati Vidyapeeth College of Pharmacy, Kolhapur

Near Chitranagari, Kolhapur-416013, Maharashtra, India.

Website: <http://copkolhapur.bharatividyaeeeth.edu>

Pharmaceutical chemistry lab I



Pharmaceutical Chemistry lab II

Bharati Vidyapeeth College of Pharmacy, Kolhapur

Near Chitranagari, Kolhapur-416013, Maharashtra, India.

Website: <http://copkolhapur.bharatividyaeeeth.edu>



Kolhapur, Maharashtra, India
M62X+J9J, near Chitranagri, Kolhapur, Maharashtra 416013, India
Lat 16.651554°
Long 74.248675°
11/10/23 11:11 AM GMT +05:30

GPS Map Camera

Pharmacognosy Lab



Kolhapur, Maharashtra, India
M62X+J9J, near Chitranagri, Kolhapur, Maharashtra 416013, India
Lat 16.651554°
Long 74.248675°
11/10/23 11:11 AM GMT +05:30

GPS Map Camera

Pharmacology Lab I

Bharati Vidyapeeth College of Pharmacy, Kolhapur

Near Chitranagari, Kolhapur-416013, Maharashtra, India.

Website: <http://copkolhapur.bharatividyaeeeth.edu>



Pharmacology Lab III

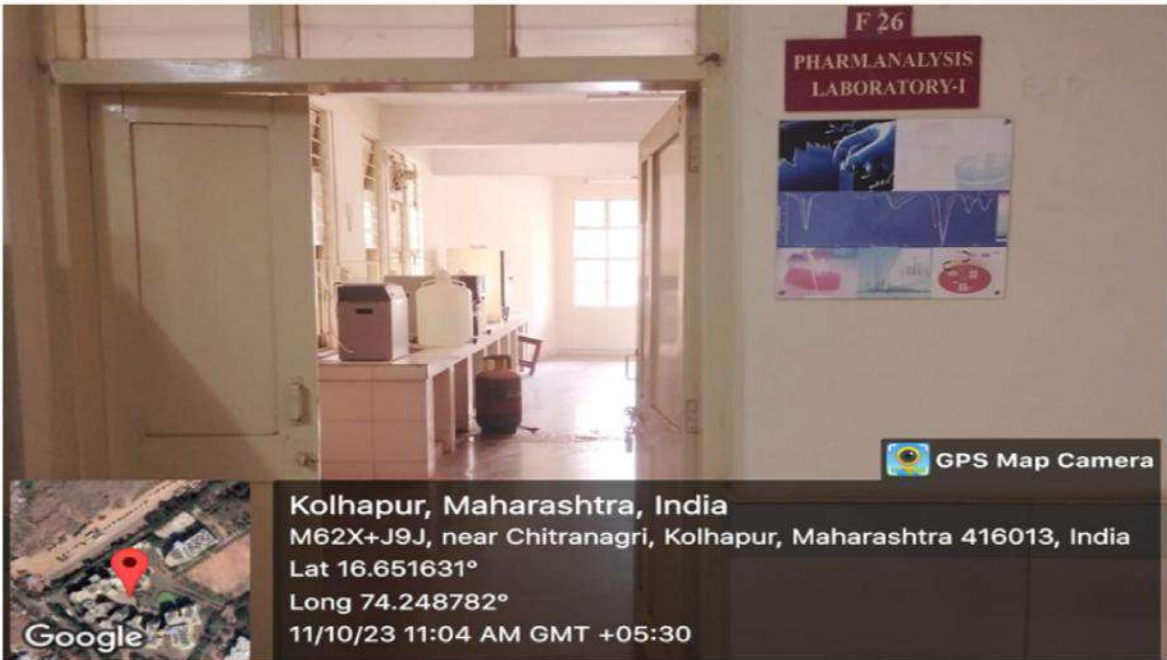

Pharmaceutical Analysis Lab

Bharati Vidyapeeth College of Pharmacy, Kolhapur

Near Chitranagari, Kolhapur-416013, Maharashtra, India.

Website: <http://copkolhapur.bharatividyaeeeth.edu>



Pharmaceutical Chemistry Lab

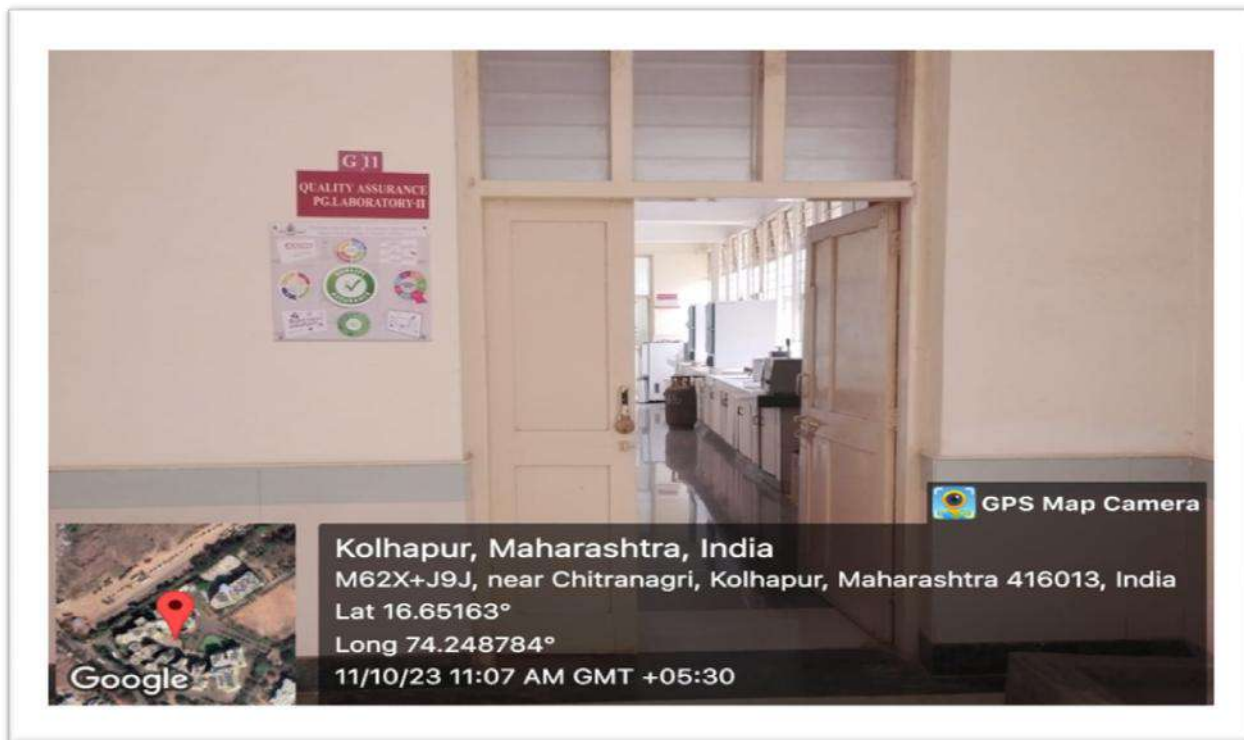

Quality Assurance PG Lab

Bharati Vidyapeeth College of Pharmacy, Kolhapur

Near Chitranagari, Kolhapur-416013, Maharashtra, India.

Website: <http://copkolhapur.bharatividyaapeeth.edu>

4: Common Facilities Centre/Instrument Room

| Sr. No. | Instrument Name | Manufacturer/ Company | Model no | Qty in nos. | SOP and Log book availability |
|---------|--|--------------------------|-----------------|-------------|-------------------------------|
| 1. | CO ₂ Incubator | EPPENDORF | Galaxy 170 | 1 | Yes |
| 2. | UV - VIS Spectrophotometer | SHIMADZU | UV 1800 | 1 | Yes |
| 3. | Blood Cell Counter | AGD BIOMEDICAL | PCE 210 | 1 | Yes |
| 4. | Inverted Phase Microscope | FUSIONTEK | Axiom INV 30 | 1 | Yes |
| 5. | UV - Visible Spectrophotometer | JASCO | V-630 | 1 | Yes |
| 6. | Single Unit Organ Bath | ORCHID SCIENTIFIC | M2K6-I240 | 1 | Yes |
| 7. | Cooling Centrifuge | REMI | CM 12 PLUS | 1 | Yes |
| 8. | IMark Microplate Reader (ELISA) | BIO RAD | iMark | 1 | Yes |
| 9. | GPC with Inkjet printer, Breeze 2 Software | WATERS | Waters 2414 | 1 | Yes |
| 10. | Auto analyzer | MERCK | Micro lab 300LX | 1 | Yes |
| 11. | HPLC-DAD | JASCO | MD -2010 | 1 | Yes |

Bharati Vidyapeeth College of Pharmacy, Kolhapur

Near Chitranagari, Kolhapur-416013, Maharashtra, India.

Website: <http://copkolhapur.bharatividyaeeeth.edu>

| | | | | | |
|-----|---------------------------------------|---|-----------|---|-----|
| 12. | Electronic Balance | SHIMADZU | ELB300 | 1 | Yes |
| 13. | Analog Hygrometer | BARIGO GERMAN | Q.C.56 | 1 | Yes |
| 14. | Digital Thermo Hygrometer | TEMP TEC | M-288-TH | 1 | Yes |
| 15. | UV - Visible Spectrophotometer | JASCO | V-630 | 1 | Yes |
| 16. | Electronic Balance | SHIMADZU | AX200 | 1 | Yes |
| 17. | Physiological data Acquisition System | BIOPAC | MP 35 | 1 | Yes |
| 18. | Digital Electronic Balance | SHIMADZU | AX200 | 1 | Yes |
| 19. | FTIR Spectrometer | JASCO | 4100 plus | 1 | Yes |
| 20. | HPLC-UV | JASCO | UV -2075 | 1 | Yes |
| 21 | Microfluidizer Small Value Electric | Microfluidizer International corporation Canada | LM 20-30 | 1 | Yes |
| 22 | HPLC-UV | JASCO | UV -4180 | 1 | Yes |
| 23 | Uv-visible Spectrophotometer | JASCO | UV-1900 | 1 | Yes |

Bharati Vidyapeeth College of Pharmacy, Kolhapur

Near Chitranagari, Kolhapur-416013, Maharashtra, India.

Website: <http://copkolhapur.bharatividyaeeeth.edu>



Common Facilities Laboratory

Layout of C.F.C

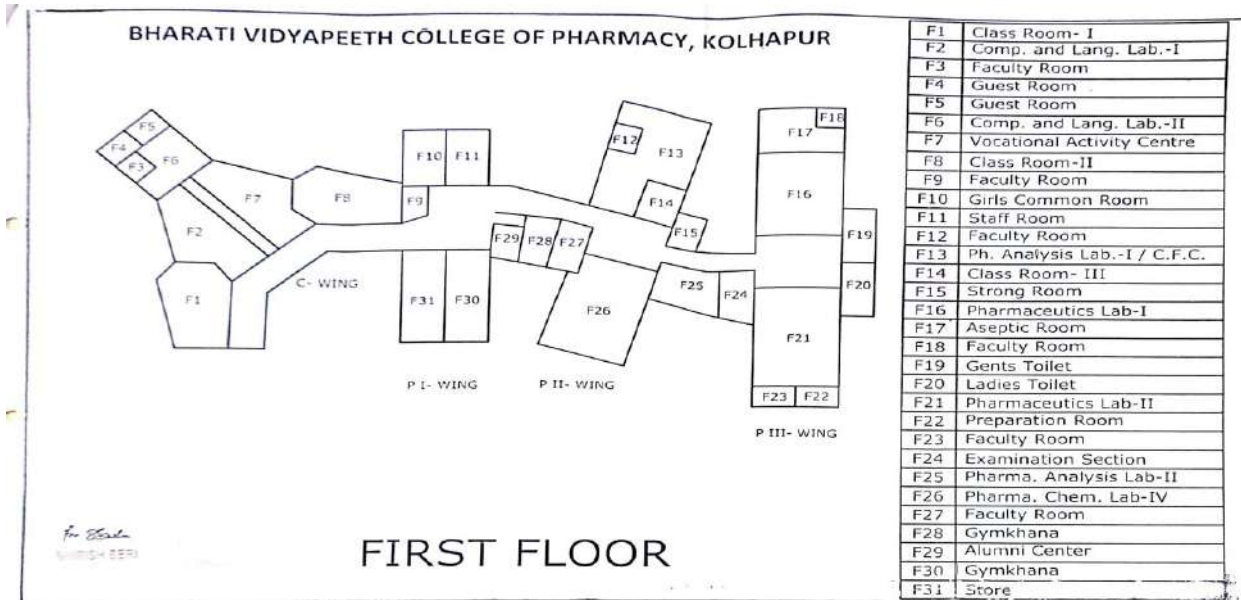

Bharati Vidyapeeth College of Pharmacy, Kolhapur

Near Chitranagari, Kolhapur-416013, Maharashtra, India.

Website: <http://copkolhapur.bharatividyaeeeth.edu>

Instruments:



Centrifuge Machine



Microfluidizer

Bharati Vidyapeeth College of Pharmacy, Kolhapur

Near Chitranagari, Kolhapur-416013, Maharashtra, India.

Website: <http://copkolhapur.bharatividyaeeeth.edu>



UV spectrophotometer



Infrared Spectrophotometer

Bharati Vidyapeeth College of Pharmacy, Kolhapur

Near Chitranagari, Kolhapur-416013, Maharashtra, India.

Website: <http://copkolhapur.bharatividyaeeeth.edu>

5: Machine Room

List of Machines

| Sr. No. | Instrument Name | Manufacturer/ Company | Model no | Qty in nos. | SOP and Log book availability |
|---------|---|-----------------------|-----------------|-------------|-------------------------------|
| 1. | All-purpose machine | VJ Instruments | Table top model | 1 | Yes |
| 2. | Programmable disintegration Apparatus | Veego | VTD-D | 1 | Yes |
| 3. | Tablet Hardness Tester | Harrison | Pfizer Type | 1 | Yes |
| 4. | Sieve Shaker | Orchid | J-91 | 1 | Yes |
| 5. | Digital advanced tablet friability test app. | Veego | VFT-DV | 1 | Yes |
| 6. | Hot air oven (digital display Size: 45x45x60) | Aditi Asso. | S.S. | 1 | Yes |
| 7. | Microprocessor environmental Test Chamber | Samruddhi | CHM-65 | 1 | Yes |
| 8. | Ball mill | Abhaykumar | JAR-SS | 1 | Yes |
| 9. | Spray drier | Labultima | LU-222 | 1 | Yes |

Bharati Vidyapeeth College of Pharmacy, Kolhapur

Near Chitranagari, Kolhapur-416013, Maharashtra, India.

Website: <http://copkolhapur.bharatividyaeeeth.edu>

| | | | | | |
|-----|---|-----------------|-----------------|---|-----|
| 10. | Tablet coating pan with Hot air | Sai Enterprises | S.S. | 1 | Yes |
| 11. | Tablet Hardness Tester(Pfizer Type) | Dolphin | Pfizer Type | 1 | Yes |
| 12. | Tablet Hardness Tester(Monsanto Type)0-20Kg | Dolphin | Monsanto Type | 1 | Yes |
| 13. | Moisture Balance | Rajdhani | RSMA-5 | 1 | Yes |
| 14. | Tablet Dissolution Tester 'TDT-08L' | Electrolab | TDT-08L | 1 | Yes |
| 15. | Tablet Machine 10Station | Rimek | Mini Press - I | 1 | Yes |
| 16. | Autoclave S.S. 12x12" | Lab-Hosp | S.S. | 1 | Yes |
| 17. | Hand Grinding Mill Table Model Coarse & Fine Grinding | Lab-Hosp | Table Top Model | 1 | Yes |

Tabular data indicating Computer laboratories & IT infrastructure

| Lab Description | Batch size (Carpet area in sq. m) | Availability of Manuals | Quality of instruments | Safety measures |
|------------------|--------------------------------------|----------------------------|------------------------------------|--------------------|
| Computer Lab-I | 20 136.00 | Yes | Computers/ Scanner /Printers | Yes |
| Computer Lab-II | 20 37.86 | Yes | Computers/ Scanner /Printers | Yes |
| Computer Lab-III | 20 10.00 | Yes | Computers/ Scanner /Printers | Yes |

Bharati Vidyapeeth College of Pharmacy, Kolhapur

Near Chitranagari, Kolhapur-416013, Maharashtra, India.

Website: <http://copkolhapur.bharatividyaeeeth.edu>

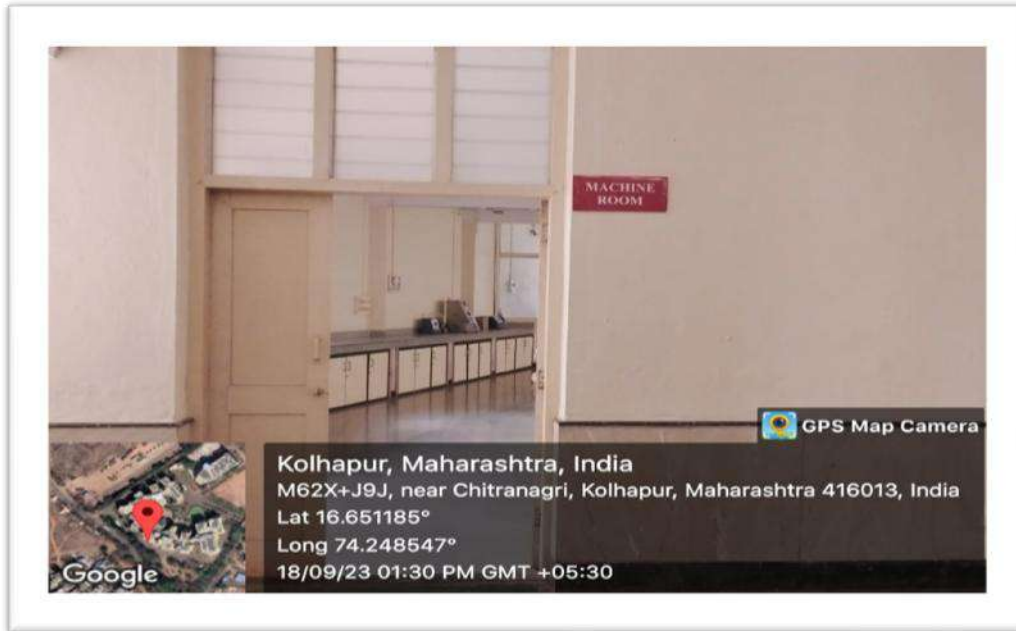

Machine Room



Bharati Vidyapeeth College of Pharmacy, Kolhapur

Near Chitranagari, Kolhapur-416013, Maharashtra, India.

Website: <http://copkolhapur.bharatividyaeeeth.edu>



Aseptic room

6: Training and placement cell

The college organizes the in-plant training for the third and fourth year B.Pharm students in reputed pharmaceutical industries and many of them are recruited in multinational and Indian pharmaceutical industries through the college campus interviews.

Our students are placed with

Zyduscadila - Ahmedabad

Cipla Pharmaceuticals - Mumbai

Glaenmark Pharmaceuticals - Mumbai

Macleods Pharmaceuticals - Mumbai

Career Options for Pharmacy profession in India:

India has a vast and growing pharmaceutical industry. Pharmacy offers reasonably good career opportunities both by way of jobs as well as in terms of starting your own business. The job avenues for a pharmacist are with pharmaceutical industry, government departments, universities, teaching hospitals, investigation and research institute etc. Within the pharmaceutical industry you might be involved in activities relating to the development, formulation, production or marketing of new drugs for clinical use. M.Pharm or Ph.D holders are normally absorbed in research work, to develop new useful drugs, in laboratories and in production work in pharmaceutical industry and analyzing them for purity and strength. Pharmacist may also take up teaching as a profession as lectures in pharmacy colleges and universities.

Bharati Vidyapeeth College of Pharmacy, Kolhapur

Near Chitranagari, Kolhapur-416013, Maharashtra, India.

Website: <http://copkolhapur.bharatividyaeeeth.edu>

Placement Cell



Bharati Vidyapeeth College of Pharmacy, Kolhapur

Near Chitranagari, Kolhapur-416013, Maharashtra, India.

Website: <http://copkolhapur.bharatividyaeeeth.edu>

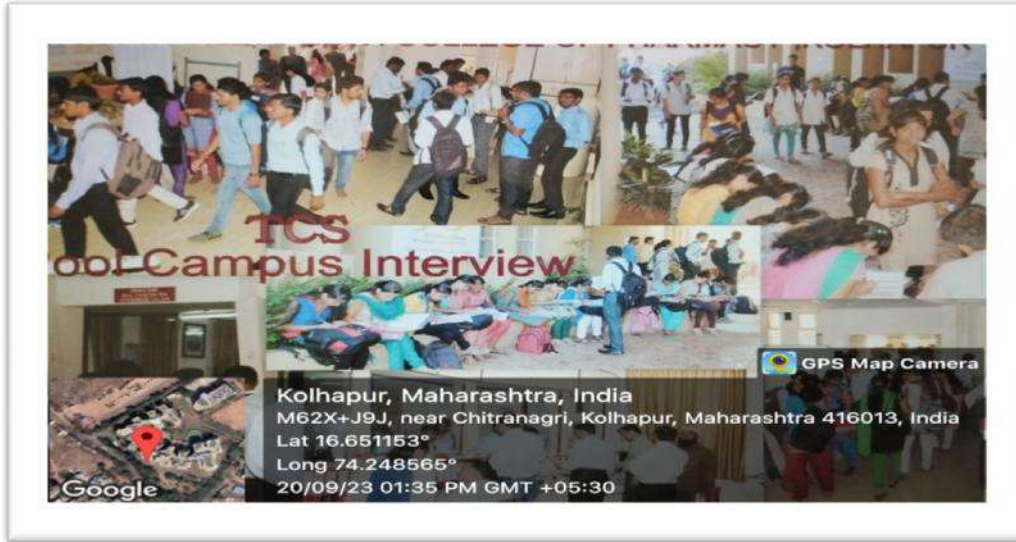

Pool Campus Drive of TCS



Inaugural programme of pool Campus

Advisory board Placement cell

| Sr.No. | Name | Designation |
|--------|-------------------|---|
| 1. | Dr. H. N. More | Principal |
| 2. | Dr. M. S. Bhatia | Vice-Principal |
| 3. | Dr. A. J. Shinde | Co-ordinator, Training & Placement Cell |
| 4. | Mr. R. J. Jarag | Member |
| 5. | Dr. F. A. Tamboli | Member |
| 6. | Guardian/Mentors | Member |

Bharati Vidyapeeth College of Pharmacy, Kolhapur

Near Chitranagari, Kolhapur-416013, Maharashtra, India.

Website: <http://copkolhapur.bharatividyaepeth.edu>

7: Cultural Activities



Inaugural program of kala mahostav



Mime

Bharati Vidyapeeth College of Pharmacy, Kolhapur

Near Chitranagari, Kolhapur-416013, Maharashtra, India.

Website: <http://copkolhapur.bharatividyaeeeth.edu>

8: Gymnasium



Bharati Vidyapeeth College of Pharmacy, Kolhapur

Near Chitranagari, Kolhapur-416013, Maharashtra, India.

Website: <http://copkolhapur.bharatividyaeeeth.edu>



Bharati Vidyapeeth College of Pharmacy, Kolhapur

Near Chitranagari, Kolhapur-416013, Maharashtra, India.

Website: <http://copkolhapur.bharatividyaepeth.edu>

9: ICT facilities



Bharati Vidyapeeth College of Pharmacy, Kolhapur

Near Chitranagari, Kolhapur-416013, Maharashtra, India.

Website: <http://copkolhapur.bharatividyaeeeth.edu>



Bharati Vidyapeeth College of Pharmacy, Kolhapur

Near Chitranagari, Kolhapur-416013, Maharashtra, India.

Website: <http://copkolhapur.bharatividyaeeeth.edu>



Biometric machine



Printer

Bharati Vidyapeeth College of Pharmacy, Kolhapur

Near Chitranagari, Kolhapur-416013, Maharashtra, India.

Website: <http://copkolhapur.bharatividyaeeeth.edu>



Artificial Intelligence Lab



Projector

10: Sports activities

Outdoor games:



Bharati Vidyapeeth College of Pharmacy, Kolhapur

Near Chitranagari, Kolhapur-416013, Maharashtra, India.

Website: <http://copkolhapur.bharatividyaeeeth.edu>



Indoor games:



Bharati Vidyapeeth College of Pharmacy, Kolhapur

Near Chitranagari, Kolhapur-416013, Maharashtra, India.

Website: <http://copkolhapur.bharatividyaeeeth.edu>



Bharati Vidyapeeth College of Pharmacy, Kolhapur

Near Chitranagari, Kolhapur-416013, Maharashtra, India.

Website: <http://copkolhapur.bharatividyaeeeth.edu>



Bharati Vidyapeeth College of Pharmacy, Kolhapur

Near Chitranagari, Kolhapur-416013, Maharashtra, India.

Website: <http://copkolhapur.bharatividyaeeeth.edu>

11: NSS activity



Bharati Vidyapeeth College of Pharmacy, Kolhapur

Near Chitranagari, Kolhapur-416013, Maharashtra, India.

Website: <http://copkolhapur.bharatividyaeeeth.edu>

12: Yoga centre



Bharati Vidyapeeth College of Pharmacy, Kolhapur

Near Chitranagari, Kolhapur-416013, Maharashtra, India.

Website: <http://copkolhapur.bharatividyaeeeth.edu>



GPS Map Camera



Google

Kolhapur, Maharashtra, India
M78C+H79, Ujalaiwadi, Kolhapur, Maharashtra 416004, India
Lat 16.665577°
Long 74.271137°
16/10/23 10:56 AM GMT +05:30



GPS Map Camera



Google

Kolhapur, Maharashtra, India
M78C+H79, Ujalaiwadi, Kolhapur, Maharashtra 416004, India
Lat 16.665577°
Long 74.271137°
16/10/23 10:59 AM GMT +05:30

Bharati Vidyapeeth College of Pharmacy, Kolhapur

Near Chitranagari, Kolhapur-416013, Maharashtra, India.

Website: <http://copkolhapur.bharatividyaapeeth.edu>



13: Drug Museum

The institute has a well-maintained drug museum at two different places. One museum located at ground floor displays marketed drug formulations, cosmetics, chemical models, drug discovery and development process, etc. for easy access creating interest in outcomes of learning pharmaceutical sciences while other museum at second floor displays crude drugs, herbal formulations and informative charts related with family planning and rational use of drugs.

A smart display for digital museum is available in the main entrance lobby which displays all current updates in pharmaceutical sciences, drug discovery, product development, herbal products, drug marketing and health sciences.

The shelf of the museum is divided into following sections:

Ground floor:

- History of Pharmacy Profession with the photograph
- Various formulations and its classifications as
 - ✓ Solid dosage form
 - ✓ Oral liquid
 - ✓ Aerosols
 - ✓ Sterile formulation
 - ✓ Cosmetic preparation
 - ✓ Packaging material
 - ✓ OTC Products

Second Floor:

- ✓ Crude drugs
- ✓ Ayurvedic formulation
- ✓ Different methods of contraception
- ✓ Rational use of drugs

Bharati Vidyapeeth College of Pharmacy, Kolhapur

Near Chitranagari, Kolhapur-416013, Maharashtra, India.

Website: <http://copkolhapur.bharatividyaeeeth.edu>



Department of Pharmaceutics



Department of Pharmaceutical Chemistry

Bharati Vidyapeeth College of Pharmacy, Kolhapur

Near Chitranagari, Kolhapur-416013, Maharashtra, India.

Website: <http://copkolhapur.bharatividyaeeeth.edu>



Department of Pharmacognosy



Department of Pharmacology

14: Medicinal plant garden

Institute has well-maintained medicinal plant garden which includes an arboretum of more than 100 medicinal plants in an area of about 505.26 sq. m. The objective of establishing this garden is to maintain most common and important species of medicinal and aromatic plants which are being used in day-to-day health care. All the plant species were authenticated by expert taxonomists, labeled and in many cases their therapeutic values in curing different diseases are also highlighted.

The medicinal garden lay out has been designed in such way that the bigger medicinal plants are maintained at the periphery of garden and are drip irrigated.

| Common Name | Binomial name | Family | Uses |
|-------------|--|----------------|---|
| Almond | <i>Prunus amygdalus</i> L. | Rosaceae | Vit' E' supplement |
| Alu | <i>Colocasia esculenta</i> (L.) Schott | Araceae | Laxative & Demulcent |
| Amarbel | <i>Cuscuta approximata</i> L. | Cuscutaceae | Constipation, liver, spleen diseases |
| Amla | <i>Emblica officinalis</i> Gaertn | Phyllanthaceae | Refrigerant, Vit 'C' supplement, Diuretic |
| Anjir | <i>Ficus reticulata</i> Miq. | Moraceae | Anthelmintic, analgesic and anti-inflammatory |
| Arjuna | <i>Terminalia arjuna</i> Roxb. | Combretaceae | Cardio tonic |
| Asgand | <i>Withania somnifera</i> L. | Solanaceae | Dietary supplements |
| Bael | <i>Aegle marmelos</i> (L.) Correa | Rutaceae | Antidiabetic |
| Bahupatra | <i>Phyllanthus niruri</i> L. | Phyllanthaceae | Anti-ulcer, anti-microbial, anti-inflammatory |
| Banana | <i>Musa acuminata</i> Colla | Musaceae | To treat dysentery, diarrhea and malignant ulcers |
| Beheda | <i>Terminalia belerica</i> | Combretaceae | Astringent |

Bharati Vidyapeeth College of Pharmacy, Kolhapur

Near Chitranagari, Kolhapur-416013, Maharashtra, India.

Website: <http://copkolhapur.bharatividyaapeeth.edu>

| | | | |
|-------------------------------|--|------------------|--|
| | (Gaertn.) Roxb. | | |
| Betel | <i>Piper betel</i> L. | Piperaceae | Stimulant, antiseptic & breath-freshner |
| Black nightshade | <i>Solanum nigrum</i> L. | Solanaceae | Ulcers and skin diseases |
| Black pepper | <i>Piper nigrum</i> L. | Piperaceae | Appetizer, Anti-flatulent |
| Blackboard tree | <i>Alstonia scholaris</i> (L.) R.Br. | Apocynaceae | Malaria, epilepsy, asthma |
| Brahma Kamal | <i>Saussurea obvallata</i> (DC.) Edgew | Asteraceae | In urinary tract infection |
| Brahmi | <i>Bacopa monnieri</i> (L.) Pennell | Scrophulariaceae | Nerve tonic |
| Brahmi | <i>Centella asiatica</i> (L.) Urban | Apiaceae | Nervine tonic |
| Capsicum | <i>Capsicum annum</i> L. | Solanaceae | Anti-inflammatory |
| Castor | <i>Ricinus communis</i> L. | Euphorbiacea | Constipation, leprosy and syphilis |
| Chitrak | <i>Plumbago zeylanica</i> L. | Plumbaginaceae | Stimulant digestant, expectorant and laxative |
| Cinnamon | <i>Cinnamomum cassia</i> (L.) J.Presl | Lauraceae | Flavorings, as a condiment and in cooking |
| Clove | <i>Syzygium aromaticum</i> (L.) Merrill & Perry | Myrtaceae | Dental analgesic |
| Coriander | <i>Coriandrum sativum</i> L. | Umbelliferae | Carminative |
| Cotton | <i>Gossypium herbaricum</i> L. | Malvaceae | Astringent |
| Country Gooseberry, Bhumiamla | <i>Phyllanthus niruri</i> L. | Phyllathaceae | Urinary calculi |
| Crown flower (Pink) | <i>Calotropis gignentina</i> (L.) W.T. Aiton | Apocynaceae | To treat fevers, elephantiasis, nausea, vomiting, and diarrhea |
| Curry tree | <i>Murraya koenigii</i> (L.) Sprengel | Meliaceae | Spices, Anthelmintic |
| Datura | <i>Datura stramonium</i> L. | Solanaceae | Anticholinergic |

Bharati Vidyapeeth College of Pharmacy, Kolhapur

Near Chitranagari, Kolhapur-416013, Maharashtra, India.

Website: <http://copkolhapur.bharatividyaapeeth.edu>

| | | | |
|---------------------------|--|-----------------------|--|
| Dill | <i>Anethum graveolens</i> L. | Umbelliferae | Carminative |
| Drumsticks | <i>Moringa oleifera</i> Lam. | Moringaceae | In the treatment of joint pain (rheumatism) diabetes, diarrhea, stomach pain |
| Eucalyptus | <i>Eucalyptus globules</i> Labill. | Myrtaceae | In the treatments of asthma, bronchitis |
| Fennel | <i>Foeniculum vulgare</i> Mill. | Umbelliferae | Carminative |
| Ghaneri | <i>Lantana camara</i> L. | Verbenaceae | Anthelmintic |
| Ginger | <i>Zingiber officinale</i> Roscoe | Zingiberaceae | Anti-inflammatory |
| Gokarni | <i>Clitorea ternetea</i> L. | Fabaceae | Antistress, anxiolytic and antidepressant |
| Gokhru | <i>Tribulus terrestris</i> L. | Zygophyllaceae | Diuretic |
| Golden shower | <i>Cassia fistula</i> L. | Fabaceae | Anti-inflammatory |
| Guava | <i>Psidium guajava</i> L. | Myrtaceae | Diarrhoea, dysentery |
| Gulab | <i>Rosa indica</i> L. | <i>Rosaceae</i> | Fragrance |
| Gulvel | <i>Tinospora cordifolia</i> (Thunb.) Miers | Menispermaceae | Anti stress and Anti spasmodic |
| Gunj | <i>Abrus precatorius</i> L. | Fabaceae | Laxative, expectorant |
| Gurmar | <i>Gymnema sylvestre</i> R. Br. | <i>Asclepiadaceae</i> | Anti-diabetic |
| Hadsandhi | <i>Cissus quadrangularis</i> L. | Vitaceae | Bone Fracture |
| Happy tree | <i>Camptotheca acuminata</i> Decne | Nyssaceae | Anti-cancer |
| Henna | <i>Lawsonia inermis</i> L. | Lythraceae | To treat amoebic dysentery |
| Hibiscus | <i>Hibiscus rosa sinensis</i> L. | Malvaceae | Aphrodisiac, demulcent, emmenagogue, emollient and refrigerant |
| Indian beech, Pongam tree | <i>Pongamia pinnata</i> (L.) Panigrahi | Fabaceae | Antiseptic |
| Indian mallow | <i>Abutilon indicum</i> (Link) Sweet | Malvaceae | Aphrodisiac |
| Jotismati | <i>Jatropha curcas</i> L. | Euphorbiaceae | Treatment of a wide spectrum of ailments |

Bharati Vidyapeeth College of Pharmacy, Kolhapur

Near Chitranagari, Kolhapur-416013, Maharashtra, India.

Website: <http://copkolhapur.bharatividyaeeeth.edu>

| | | | |
|----------------------|--|---------------|---|
| | | | related to skin, cancer, digestive, respiratory and infectious diseases |
| Jujube | <i>Zizyphus jujube</i> Mill. | Rhamnaceae | Rich in Disease-Fighting Vitamin C |
| Jungli pyaz | <i>Urgenia indica</i> (Roxb) Kunth. | Liliaceae | Cardiotonic, Diuretic |
| Kalmegh | <i>Andrographis Paniculata</i> (Burm.f.) Wall. ex Nees | Acanthaceae | Anthelmintic, Anti-ulcer |
| Kanchan | <i>Bauhinia variegata</i> (L.) Benth | Fabaceae | Cardiovascular |
| King's crown (White) | <i>Calotropis procera</i> (Aiton) W.T.Aiton | Apocynaceae | To treat diarrhea, constipation and stomach ulcers |
| Kokum | <i>Garcinia indica</i> Choisy | Clusiaceae | Astringent, cardiotonic and anti-allergic |
| Koranti | <i>Barleria gibsoni</i> Dalz. | Acanthaceae | Anti- ulcer |
| Korphad | <i>Aloe Vera</i> (L.) Burm.f. | Liliaceae | Purgative, , Cosmetic preparation |
| Kurudu | <i>Celosia argentea</i> L. | Amaranthaceae | Astringent, haemostatic, ophthalmic, parasiticide |
| Lemon | <i>Citrus limon</i> (L.) Osbeck | Rutaceae | Vit 'C' supplement |
| Lemon grass | <i>Cymbopogan citratus</i> (DC.) Stapf | Poaceae | Flavouring agent |
| Lendi Pimpli | <i>Piper longum</i> L. | Piperaceae | Asthma, Cough |
| Lipstic tree | <i>Bixa orellana</i> L. | Bixaceae | Food coloring |
| Mahaneem | <i>Ailanthus excels</i> Roxb. | Simaroubaceae | Digestive properties |
| Makad limboo | <i>Atlantia racemosa</i> Wight & Arn. | Rutaceae | Flavoring agent |
| Mango | <i>Mangifera indica</i> L. | Anacardiaceae | Fruit as source of vitamins, leaves antidiabetic |
| Momordica | <i>Momordica charantia</i> L. | Cucurbitaceae | Stomachic, laxative, antibilious, emetic, anthelmintic |

Bharati Vidyapeeth College of Pharmacy, Kolhapur

Near Chitranagari, Kolhapur-416013, Maharashtra, India.

Website: <http://copkolhapur.bharatividyaeeeth.edu>

| | | | |
|----------------------|--|----------------|--|
| Neem | <i>Azadirachta indica</i> A.Juss | Meliaceae | Antiviral activity |
| Nerium | <i>Nerium indicum</i> L. | Apocynaceae | Cardiotonic |
| Nirgundi | <i>Sapindus trifoliatu</i> s L. | Sapindaceae | Anti inflammatory, Antihelmintic, Insecticide, Dyeing agent |
| Nutmeg | <i>Myristica fragran</i> ce Houtt. | Myristicaceae | Sedative |
| Orange | <i>Citrus aurantium</i> L. | Rutaceae | Anxiety, Nasal congestion |
| Orchid tree | <i>Bauhinia variegata</i> (L.) Benth. | Fabaceae | Anti-inflammatory |
| Palas | <i>Butea monosperma</i> (Lam.) Taub. | Fabacea | Diuretic |
| Pan ova | <i>Coleus aromaticus</i> (Lour.) Spreng | Lamiaceae | Flavouring agent |
| Panfuti | <i>Bryophyllum pinnatum</i> (Lam.) Oken | Crassulaceae | Anti-hypertensive |
| Papaya | <i>Carica papaya</i> .L. | Caricaceae | Mild laxative |
| Pashanbheda | <i>Bergenia ligulata</i> (Wall.) Engl. | Saxifragaceae | Anti-inflammatory, analgesic and diuretic |
| Passion flower | <i>Passiflora foetida</i> L. | Passifloraceae | Anthelmintic |
| Peppermint | <i>Mentha piperita</i> L. | Lamiaceae | Flavoring, perfumes, and medicinal purposes |
| Punarnova | <i>Boerhavia diffusa</i> L. nom. cons | Nyctaginaceae | Anti inflammatory |
| Rasana | <i>Alpinia galangal</i> (L.) Willd. | Zingiberacea | Flavoring agent |
| Rauwolfia | <i>Rauwolfia tertaphylla</i> L. | Apocynaceae | Anti-hypertensive |
| Shameplant Lazalu | <i>Mimosa pudica</i> L. | Fabaceae | Astringent |
| Shankhapushpi | <i>Convolvulus pluricaulis</i> Choisy | Convolvulaceae | Brain tonic |
| Shatavari | <i>Asparagus racemosus</i> Willd | Liliaceae | For treatment of habitual abortion |

Bharati Vidyapeeth College of Pharmacy, Kolhapur

Near Chitranagari, Kolhapur-416013, Maharashtra, India.

Website: <http://copkolhapur.bharatividyaeeeth.edu>

| | | | |
|-----------------------------|--|---------------|---|
| Sweet sop, Custard apple | <i>Annona squamosa</i> L. | Annonaceae | Aids digestion, controls blood pressure |
| Tag | <i>Corchorus olitorius</i> L. | Tiliaceae | Vegetable |
| Tamarind | <i>Tamarindus indicus</i> L. | Fabaceae | Antioxidant and anti- inflammatory |
| Tarwad | <i>Cassia tora</i> (L.) Roxb. | Fabaceae | Purgative |
| Tulsi | <i>Ocimum sanctum</i> L. | Lamiaceae | Immune system booster and an anti-inflammatory |
| Turmeric | <i>Curcuma longa</i> L. | Zingiberaceae | Anti-inflammatory |
| Umbar | <i>Ficus racemose</i> L. | Moraceae | Bone healing |
| Vala | <i>Vetever ziznoides</i> L. | Poaceae | Coolant, flavoring agent |
| Vasaka | <i>Adhatoda vasica</i> L. | Acanthaceae | Bronchodilator |
| Vekhand | <i>Acorus calamus</i> L. | Acoraceae | Sedative |
| Vinca Var alba | <i>Catharanthus roseus</i> (L.) G.Don | Apocynaceae | Anti-cancer |
| Vinca Var Tropicana | <i>Catharanthus roseus</i> (L.) G.Don | Apocynaceae | Anti-cancer |
| Vinca Var Violaceae | <i>Catharanthus roseus</i> (L.) G.Don | Apocynaceae | Anti-cancer |
| Withania | <i>Withania somnifera</i> (L.) Dunal | Solanaceae | Immunomodulator |
| Zendu | <i>Calendula officinalis</i> L. | Asteraceae | Antiallergic, Coolant |

Bharati Vidyapeeth College of Pharmacy, Kolhapur

Near Chitranagari, Kolhapur-416013, Maharashtra, India.

Website: <http://copkolhapur.bharatividyaeeeth.edu>

MEDICINAL PLANT GARDEN

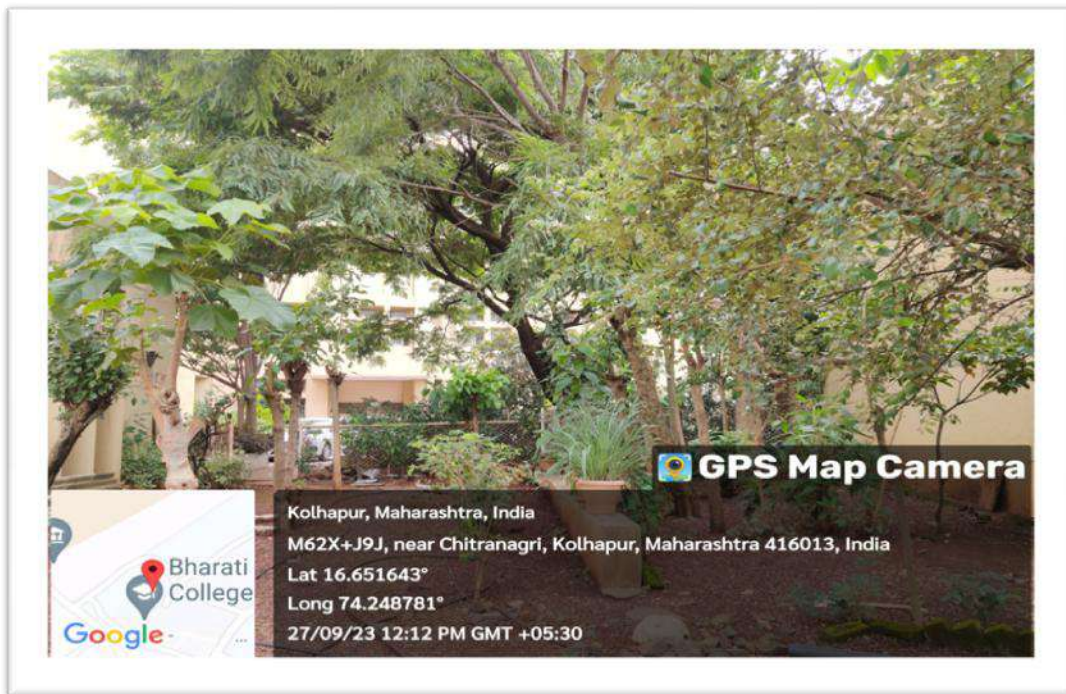

Bharati Vidyapeeth College of Pharmacy, Kolhapur

Near Chitranagari, Kolhapur-416013, Maharashtra, India.

Website: <http://copkolhapur.bharatividyaeeeth.edu>

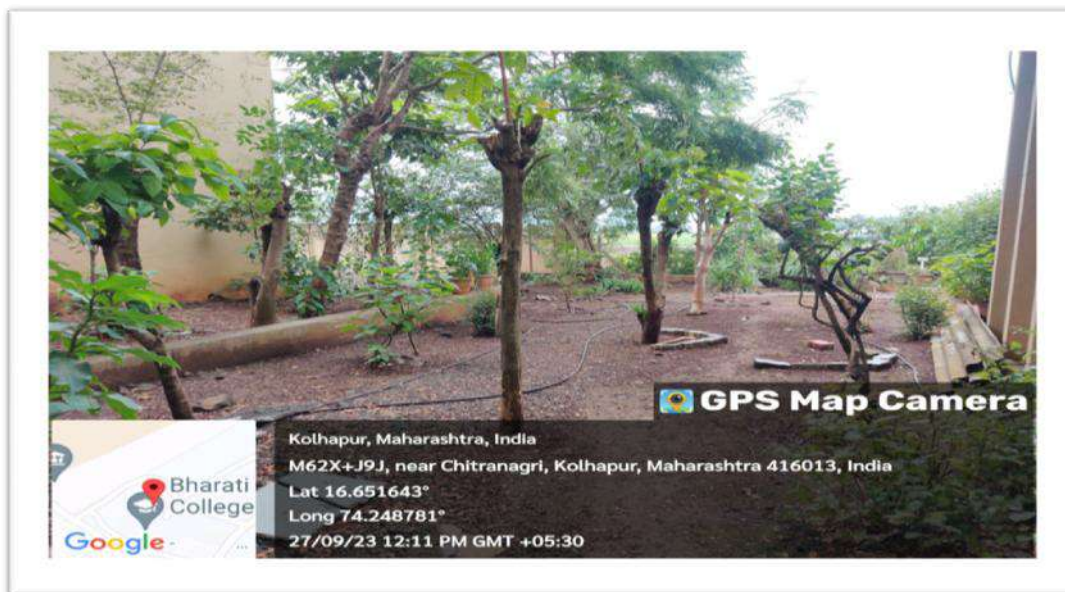

| Number of Medicinal Plants | Area |
|----------------------------|-------------|
| >100 | 505.26sq.m. |

Bharati Vidyapeeth College of Pharmacy, Kolhapur

Near Chitranagari, Kolhapur-416013, Maharashtra, India.

Website: <http://copkolhapur.bharatividyaeeeth.edu>

15: Auditorium



Bharati Vidyapeeth College of Pharmacy, Kolhapur

Near Chitranagari, Kolhapur-416013, Maharashtra, India.

Website: <http://copkolhapur.bharatividyaapeeth.edu>

16: Canteen Facility



Bharati Vidyapeeth College of Pharmacy, Kolhapur

Near Chitranagari, Kolhapur-416013, Maharashtra, India.

Website: <http://copkolhapur.bharatividyaapeeth.edu>

